



We are the only supplier of Commando & Dominator parts using the original factory drawings. Our products are mostly made in England and to original specification. We also offer Norton Rotary spares, factory service manuals and literature for **NORTON** and **TRIUMPH** motorcycles.

INSIST ON GENUINE FACTORY PARTS PACKAGED WITH THIS LOGO



THE NORTON COMMANDO CLUTCH

Andover Norton have all parts for the Norton Commando clutch. The original specification products listed here, when fitted and set up correctly in a road machine, should give an acceptably light clutch operation that does not slip or drag. Engaging first gear when moving off should not produce excessive noise, nor neutral be difficult to obtain. Andover Norton will be pleased to give technical assistance to customers purchasing clutch parts.

Part	Description	Photo
06.0751	Circlip	1
06.0770	Spring plate	1
06.2482	Sprocket & backplate	1
06.0747	Spacer	2
06.0752	Circlip	2
06.0753	Inner circlip	2
06.0754	Outer circlip	2
06.0894	Shim 0.036"	2
06.0895	Shim 0.048"	2
04.0373	Nut	3
06.0005	Adjuster nut	3
06.1179	Adjuster	3
06.3447	Washer	3
06.3459	Tab washer	3
06.0746	Plain plate	4
06.1339	Friction plate, fibre	4
06.3741	Friction plate, sintered	4
06.0749	Friction plate (early Commando)	5
06.0745	Pressure plate (fibre plates)	6
06.3768	Pressure plate (sintered plates)	6
06.3979	Clutch centre	6
06.6476	Cable, teflon lined, 46" Europe	7
06.0999	Compression tool	8
06.1015	Lock tool	8
06.0750	Bearing	9
06.2813	Cable, teflon lined, 51" USA	na
06.4963	Cable, teflon lined, 48" Europe	na

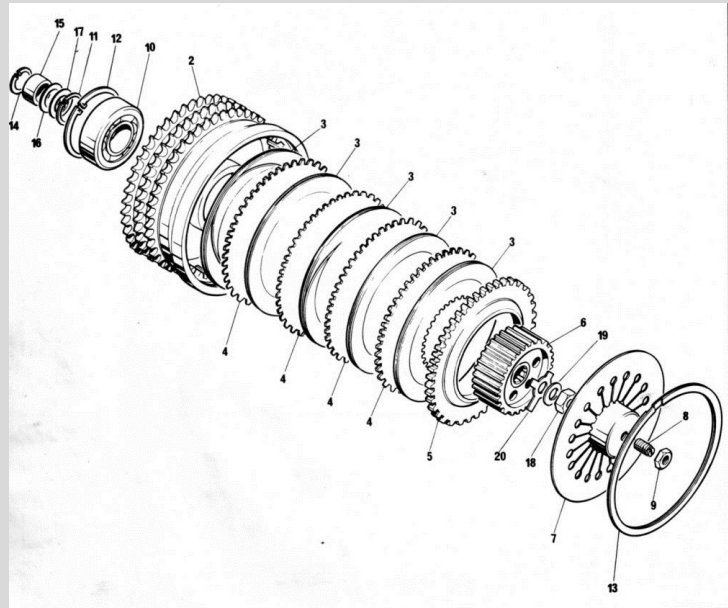
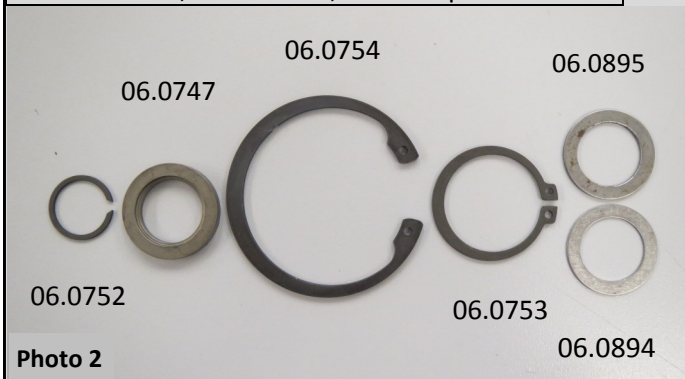

Photo 1



NOW BUY GENUINE NORTON FACTORY SPARES FROM OUR SALES COUNTER IN ANDOVER, HAMPSHIRE

Order on-line: www.andover-norton.co.uk tel: 01264 359 565 email: office@andover-norton.co.uk



We are the only supplier of Commando & Dominator parts using the original factory drawings. Our products are mostly made in England and to original specification. We also offer Norton Rotary spares, factory service manuals and literature for **NORTON** and **TRIUMPH** motorcycles.

INSIST ON GENUINE FACTORY PARTS PACKAGED WITH THIS LOGO



THE NORTON COMMANDO CLUTCH

Photo 4

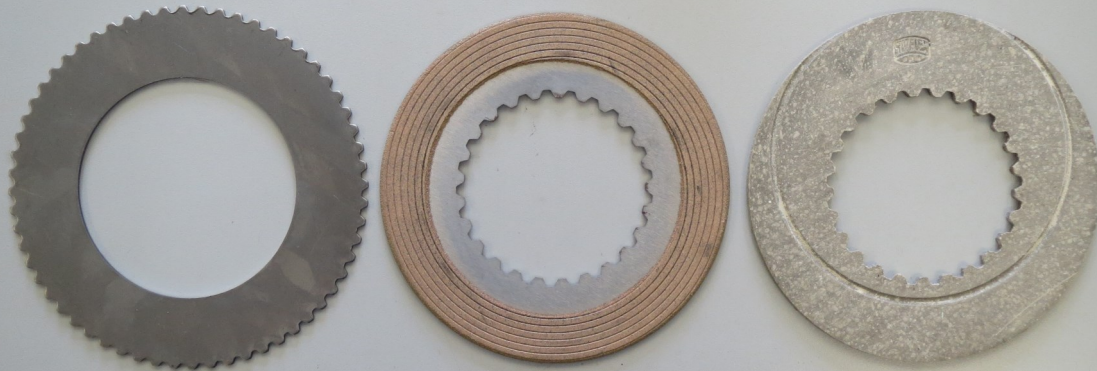

06.0746

06.3741

06.1339

06.0749

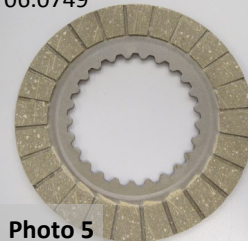

Photo 5

06.0750



Photo 9

Fit 4 fibre plates and 3 plain plates,
or

5 sintered plates and 4 plain plates

Fibre plates: use 06.0745 pressure plate

Sintered plates: use 06.3768 pressure plate

Please refer to our Website for Pricing:
www.andover-norton.co.uk

Photo 6

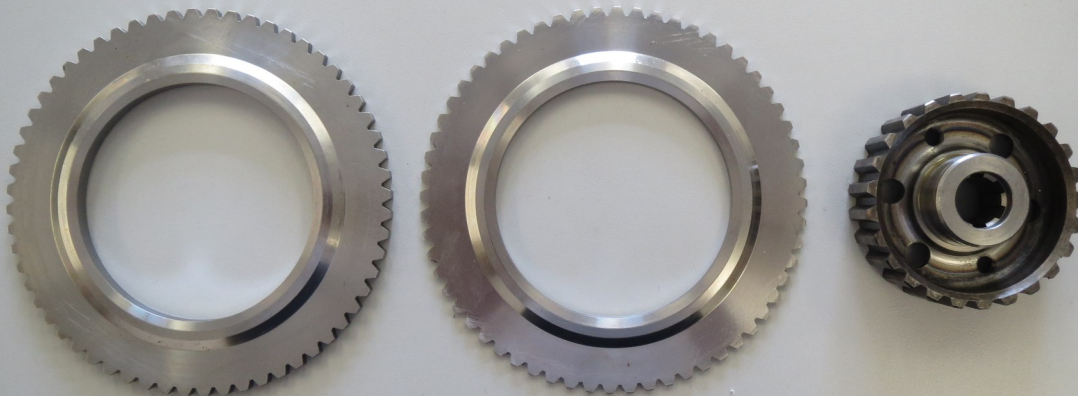

06.3768

06.0745

06.3979

Photo 7



06.6476

Photo 8



06.1015

06.0999

NOW BUY GENUINE NORTON FACTORY SPARES FROM OUR SALES COUNTER IN ANDOVER, HAMPSHIRE

Order on-line: www.andover-norton.co.uk tel: 01264 359 565 email: office@andover-norton.co.uk